

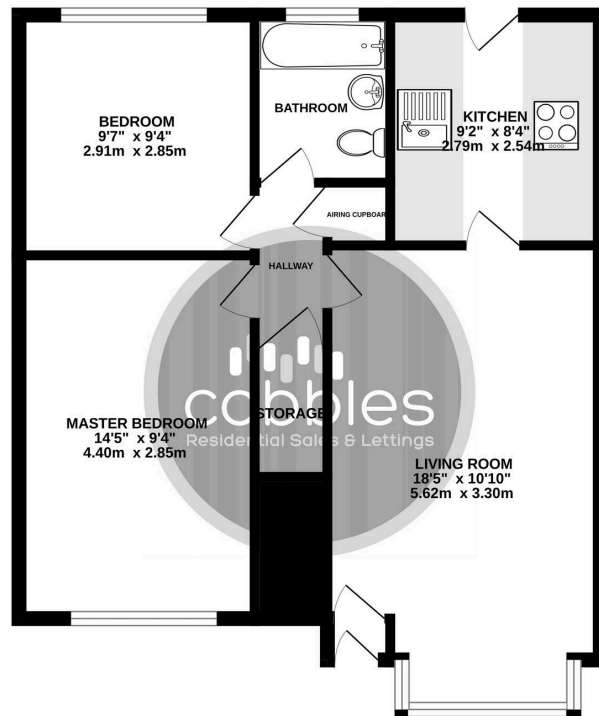



GROUND FLOOR  
571 sq.ft. (53.0 sq.m.) approx.



## Somertons Close

Guildford, Guildford

Generating your content, this won't take long...

Council Tax band: C

Tenure: Share of Freehold

EPC Energy Efficiency Rating: D

EPC Environmental Impact Rating:

- Two double Bedrooms
- Private Garden
- Allocated parking in a secure/gated carpark
- Large Reception Room
- Modern Kitchen
- Bay Window

TOTAL FLOOR AREA : 571 sq.ft. (53.0 sq.m.) approx.

Whilst every attempt has been made to ensure the accuracy of the floorplan contained here, measurements of doors, windows, rooms and any other items are approximate and no responsibility is taken for any error, omission or mis-statement. This plan is for illustrative purposes only and should be used as such by any prospective purchaser. The services, systems and appliances shown have not been tested and no guarantee as to their operability or efficiency can be given.  
Made with Metropix ©2025.

