

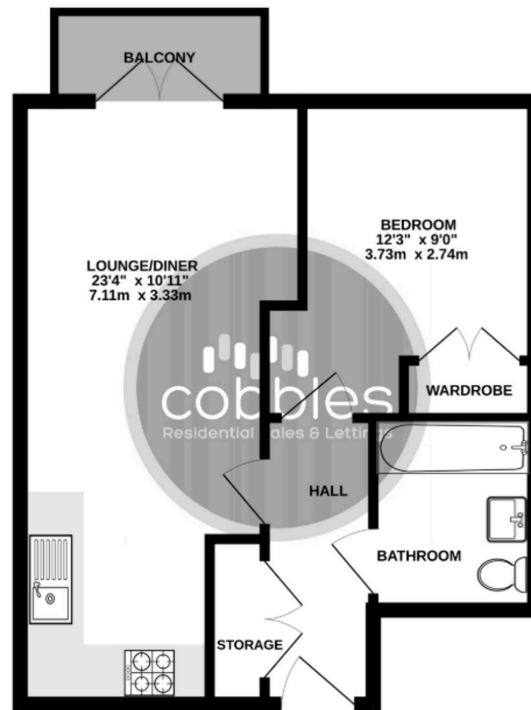

THIRD FLOOR
475 sq.ft. (44.1 sq.m.) approx.



Austen House Station View, Guildford

Council Tax band: C

Tenure: Leasehold

EPC Energy Efficiency Rating: B

EPC Environmental Impact Rating: A

- One Bedroom Flat
- Balcony
- Communal Courtyard Garden
- Secure Underground Parking
- Modern Throughout
- Town Centre Location
- EPC Rating B
- Council Tax Band C

TOTAL FLOOR AREA : 475 sq.ft. (44.1 sq.m.) approx.

Whilst every attempt has been made to ensure the accuracy of the floorplan contained here, measurements of doors, windows, rooms and any other items are approximate and no responsibility is taken for any error, omission or mis-statement. This plan is for illustrative purposes only and should be used as such by any prospective purchaser. The services, systems and appliances shown have not been tested and no guarantee as to their operability or efficiency can be given.
Made with MetreX 6/2006

