



Princess Mary Close

Guildford, Guildford

Spacious 4-bed home in quiet Guildford cul-de-sac. Open-plan living, balconies, private garden, parking. Close to top schools, amenities, and transport links. Ideal for modern family life.

Council Tax band: F

Tenure: Freehold

EPC Energy Efficiency Rating: C

EPC Environmental Impact Rating: C

- Four Bedroom House
- Chain Free
- Off Street Parking
- Arranged over Three Floors
- Private Garden
- Balconies
- Highly Desirable Queen Elizabeth Park Development

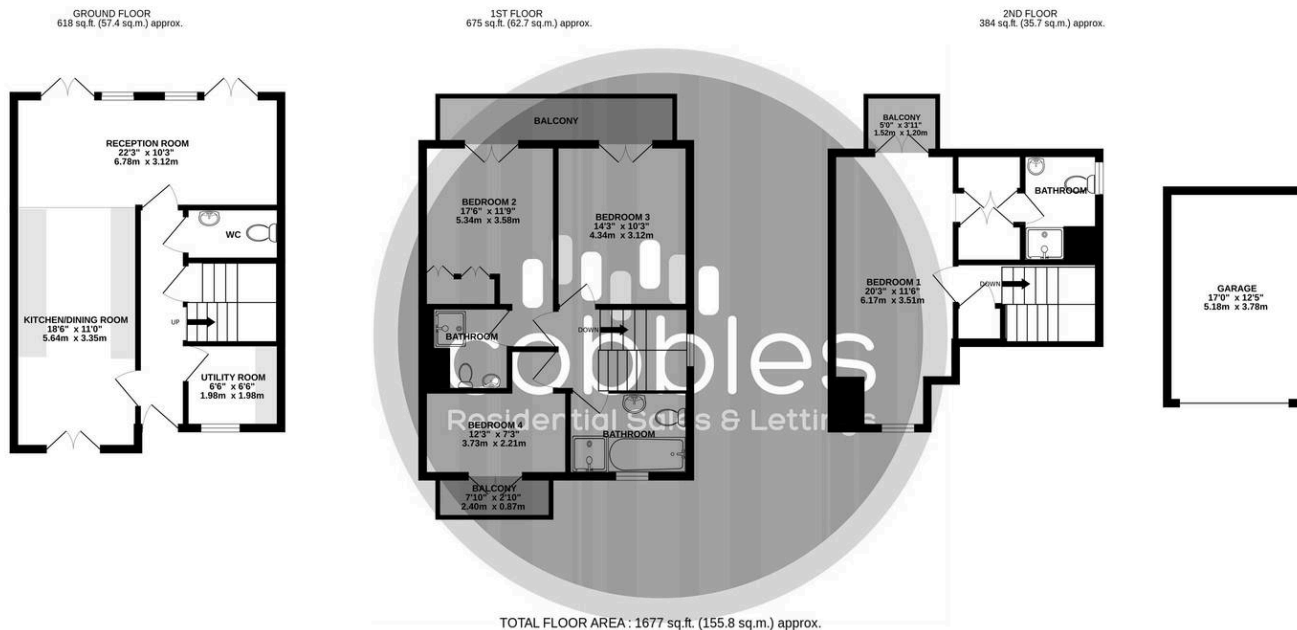

TOTAL FLOOR AREA : 1677 sq.ft. (155.8 sq.m.) approx.

Whilst every attempt has been made to ensure the accuracy of the floorplan contained here, measurements of doors, windows, rooms and any other items are approximate and no responsibility is taken for any error, omission or mis-statement. This plan is for illustrative purposes only and should be used as such by any prospective purchaser. The services, systems and appliances shown have not been tested and no guarantee as to their operability or efficiency can be given.
Made with Metropix ©2026

